

**SITE SURVEY**

**Land at Crymlyn Parc Skewen**

Notes:  
 Survey Grid  
 Plane grid related to National Grid at survey point S5  
 :270816.551mE, 196895.775mN, 63.385m  
 Survey Datum :  
 Related to GPS Datum at survey point S5

Sheet 1 of 3	Surveyed By: P.M.S.
Datum	Drawn By: P.M.S.
See Notes above for datum value.	Date of Survey: March 2018
North Point Approximate	Scale: 1:500
Client: Pobl Group	Survey Job No. SS-1082A

Revisions:

A	Additional Northern Farm land added & drainage details added March 2021
B	
C	
D	
E	

Legend:

Manhole shown thus	MH	Spot Level	+123.962
Inspection Cover	IC	Cover Level	CL 112.305
Lamp Post	LP	Invert Level	IL 111.733
Gully	GT	Foot Drain	FD
Landscape	LP	Surface Water	SW
Telegraph Post	TP	Unknown Service	US
Electricity Pole	EP	Survey Station	ST
Road Traffic Sign	RTS	Point Level	PL 10.907
British Telecom	BT	Height floor to structural soffit	SS 2.297
Cable Television	CTV	Height floor to false ceiling	FC 2.222
Fire Hydrant	FH	Height floor to all	S 0.67
Safety Valve	SV	Height of window	W 1.23
Stopcock Water	SCW	Height of door	D 1.98
Stopcock Gas	SCG	Height floor to underside of beam	UB 3.61
Unknown Stopcock	ST	Fall Pipe	FP
Tree with spread and Girth	T	Sky Light	SL
		Water Closet	WC
		Vent	V
		Spire	S
		Roof	R
		Keab	K
		Hedge	H
		Surface Edge	SE
		Fence	F
		Gate	G

**Survey Station Schedule**

Station	Easting	Northing	Level
S1	270819.004	196848.948	60.263
S2	270773.347	196831.544	58.981
S3	270763.675	196863.581	60.166
S4	270760.860	196887.228	60.834
S5	270816.551	196895.775	63.385
S6	270892.554	196908.305	64.306
S7	270835.299	196918.367	62.754
S8	270755.995	196898.840	59.850
S9	270723.366	196893.968	58.424
S10	270977.277	196914.547	65.245
S12	270911.243	196938.371	62.310
S13	271028.523	197025.600	57.752
S14	271028.869	197079.817	57.221
S15	271052.354	197082.270	56.880
S16	271058.801	197020.719	58.856
S17	271093.863	197022.031	59.174

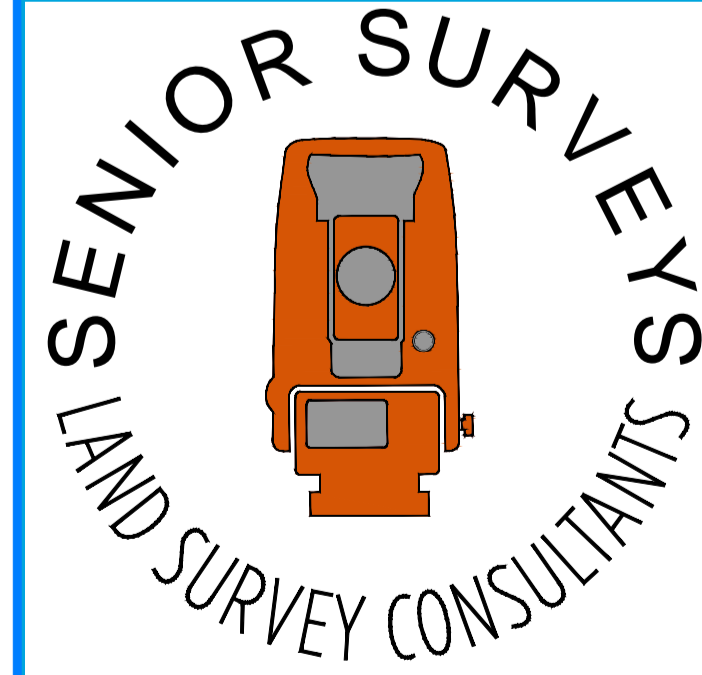

Contact Details:  
 Phil Senior  
 Unit 1E Chapel Barns  
 Merthyr Mawr  
 Bridgend  
 CF32 0LS  
 Tel: 07853240403  
 Email: Philseniorsurveys@Gmail.com