

Attenuation Basin Section A-A CH 0.000 - 19.963
SCALE: H 1:250, V 1:250

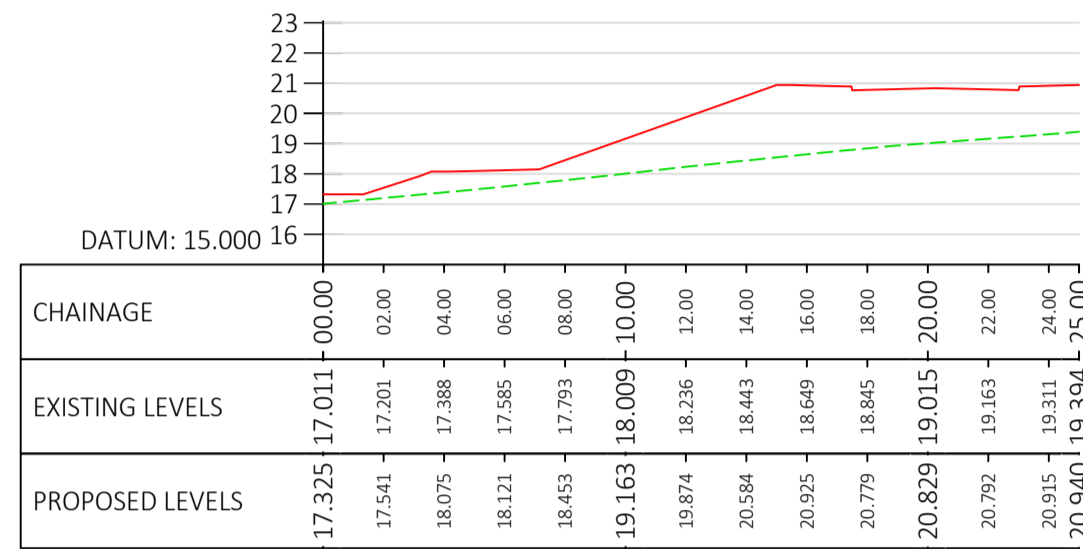

Attenuation Basin Section B-B CH 0.000 - 25.000
SCALE: H 1:250, V 1:250

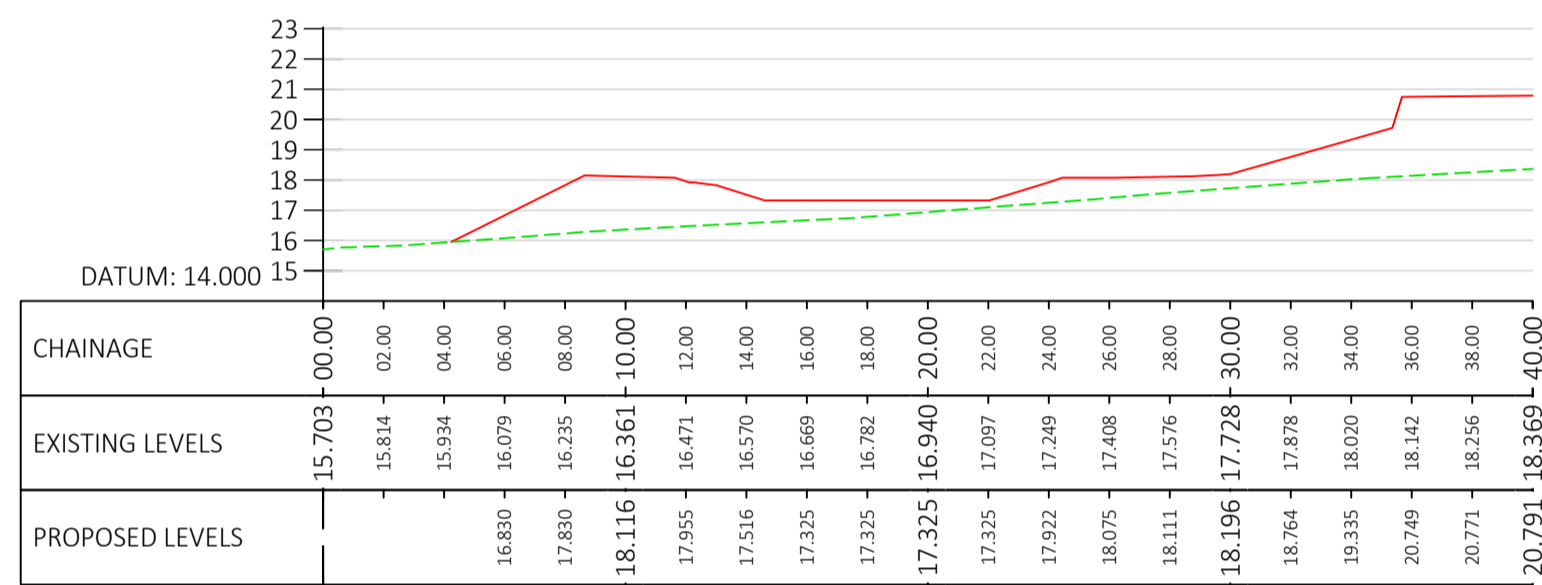

Attenuation Basin Section C-C CH 0.000 - 40.000
SCALE: H 1:250, V 1:250

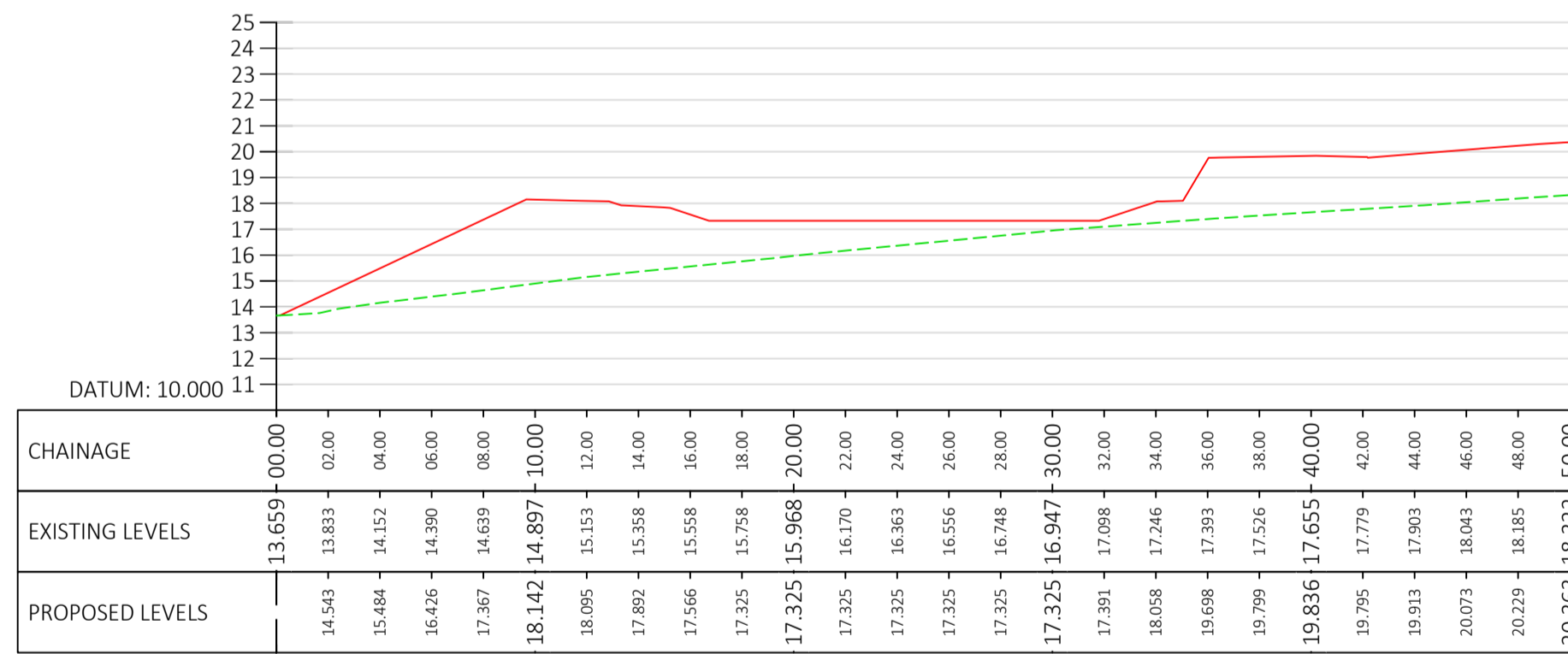

Attenuation Basin Section D-D CH 0.000 - 50.000
SCALE: H 1:250, V 1:250

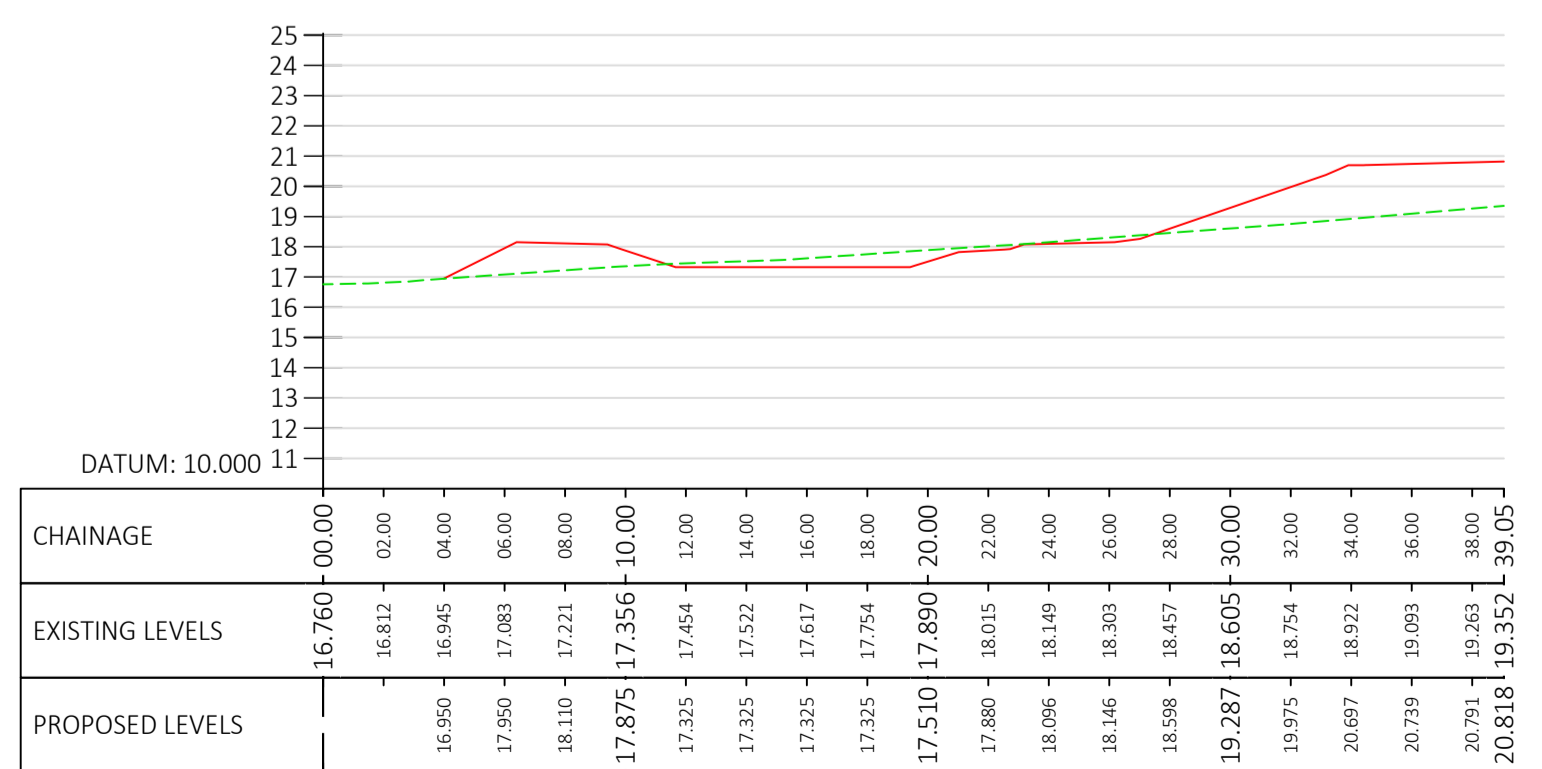

Attenuation Basin Section E-E CH 0.000 - 39.049
SCALE: H 1:250, V 1:250

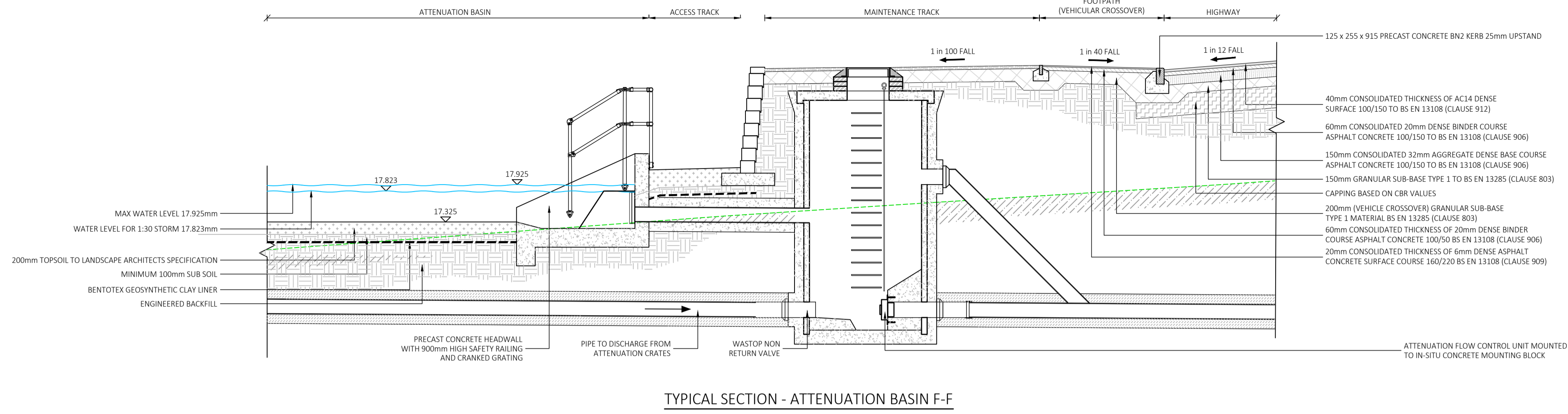

TYPICAL SECTION - ATTENUATION BASIN F-F

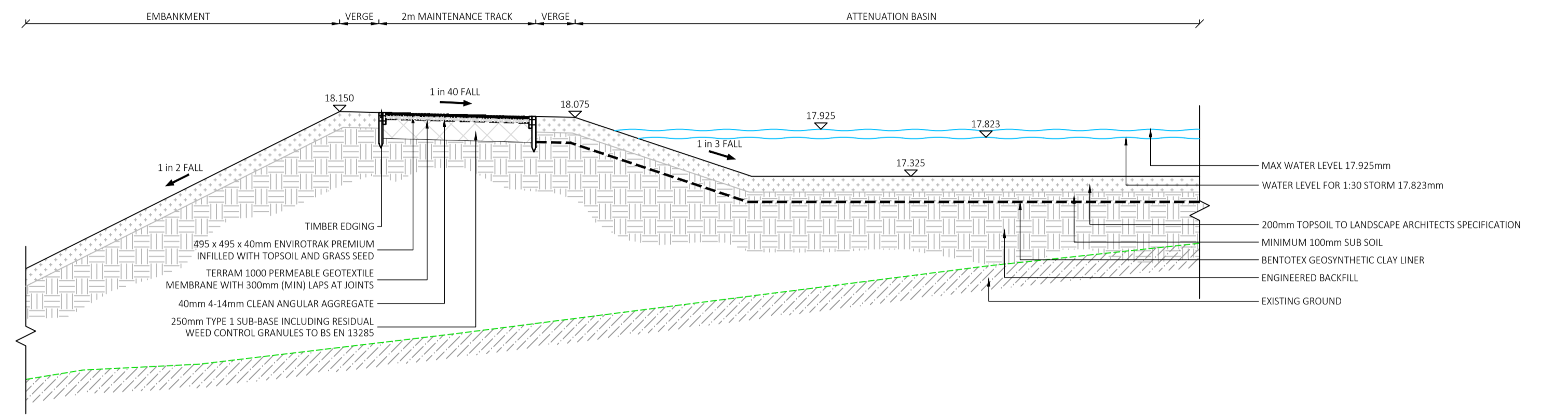

TYPICAL SECTION - ATTENUATION BASIN G-G

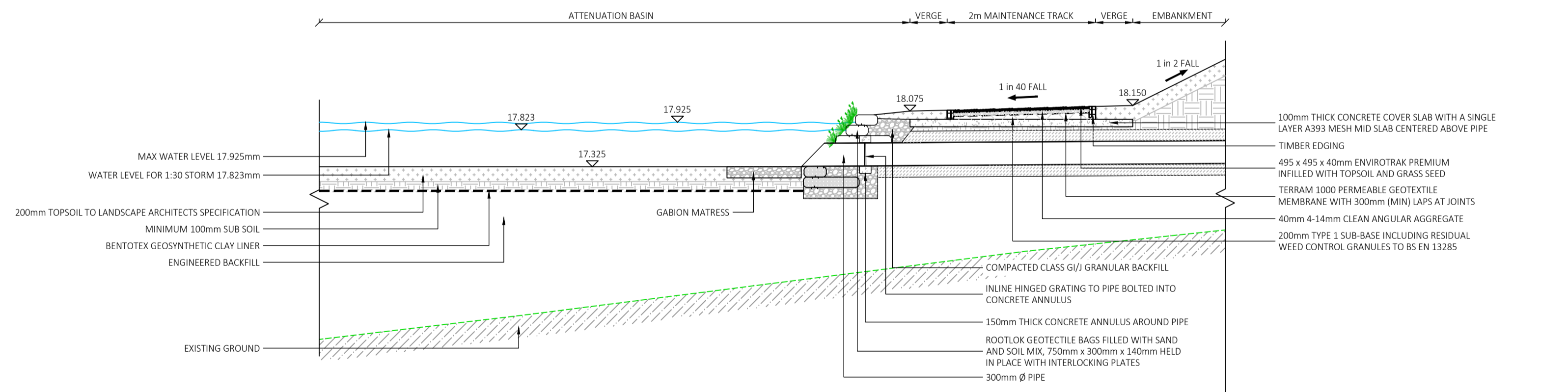

TYPICAL SECTION - ATTENUATION BASIN H-H

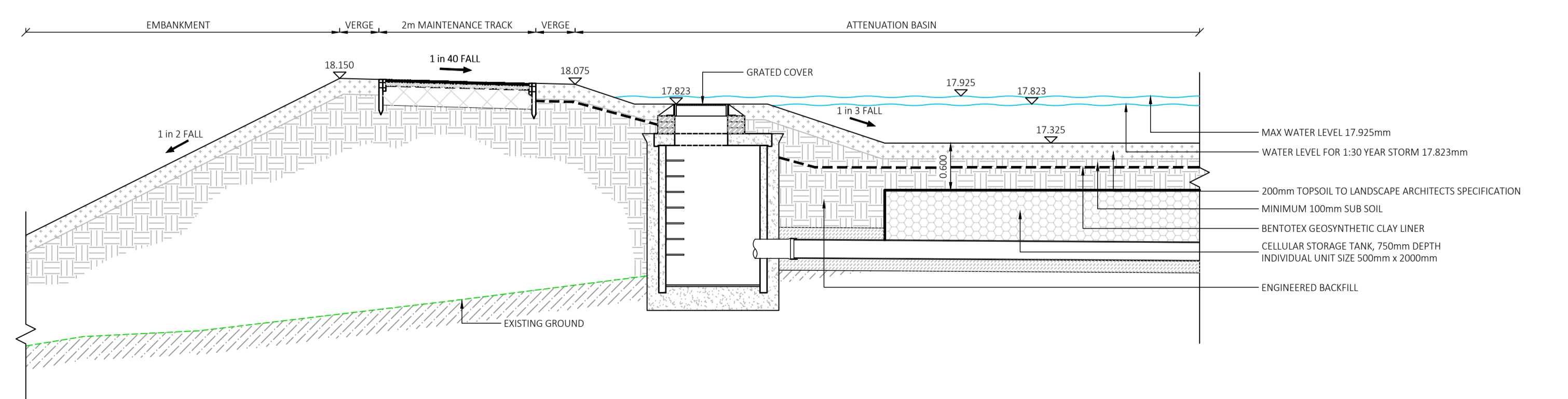

TYPICAL SECTION - ATTENUATION BASIN J-J

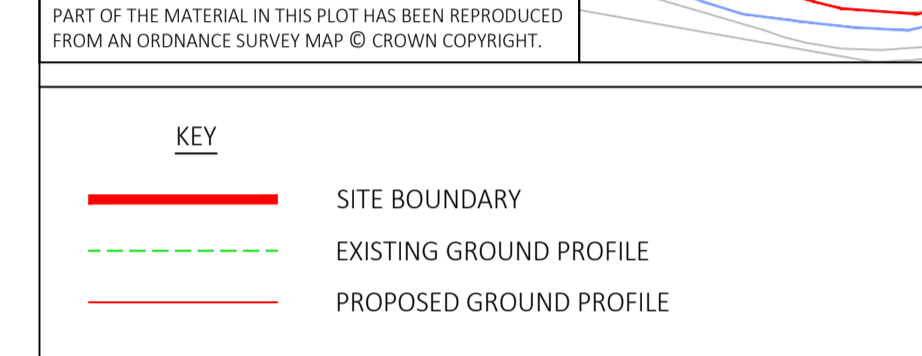
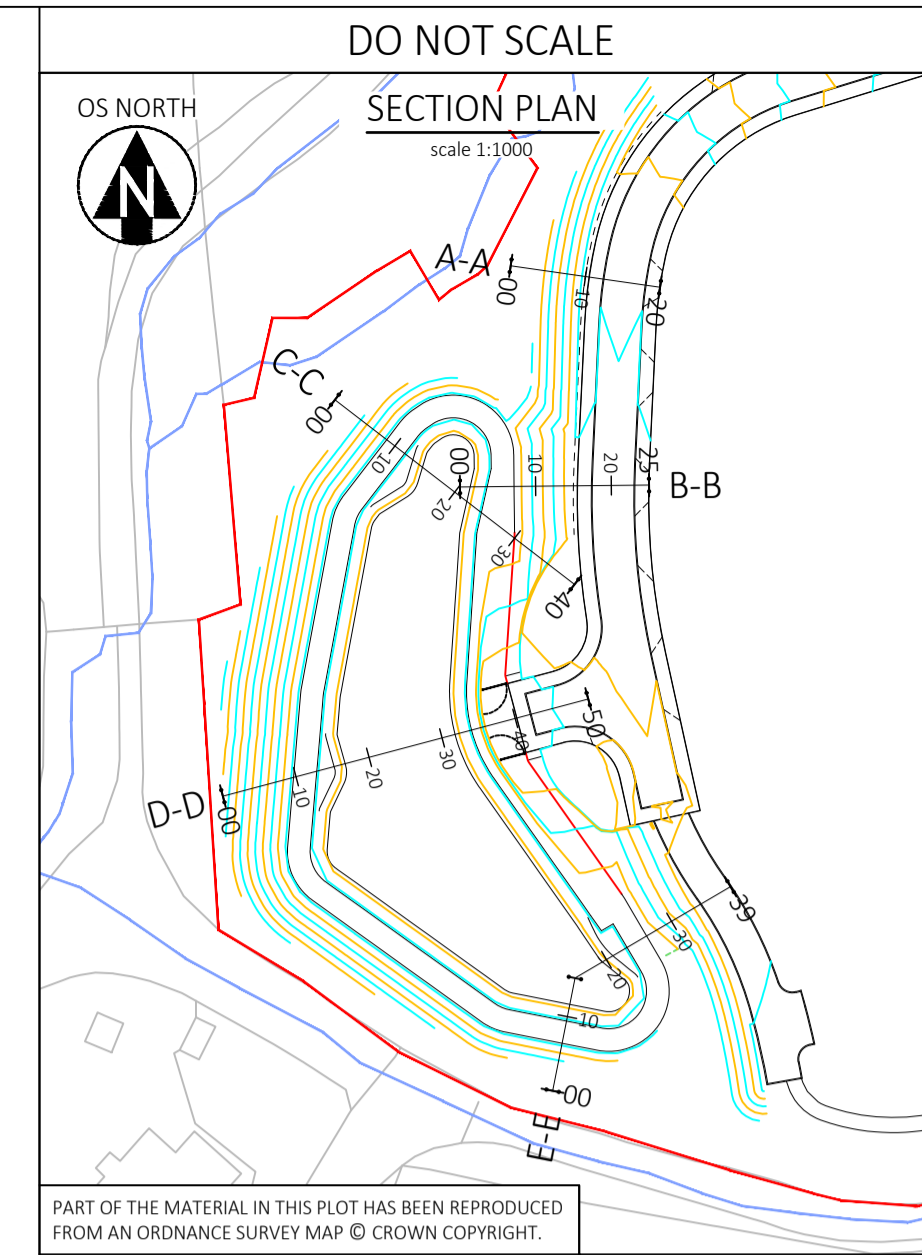

- NOTES:
- DRAWING TO BE READ IN CONJUNCTION WITH ALL OTHER RELEVANT PROJECT DRAWINGS AND SPECIFICATIONS
 - ALL FIGURED LEVELS ARE IN METRES AND RELATED TO EXISTING SURVEY GRID & DATUM UNLESS NOTED OTHERWISE
 - ALL FIGURED DIMENSIONS ARE IN METRES UNLESS NOTED OTHERWISE, DIMENSION ARE NOT TO BE SCALED.
 - APPROXIMATE MIDDLE OF SITE INFORMATION
 - GRID REFERENCE: SS 57783 99330
 - X (EASTING) 257783, Y (NORTHING) 199330
 - What3Words: pass.clever.decanter

REVISIONS				
Rev.	Revision Notes	Date	Drawn By	Checked / Approved
P02	General Update	18/09/24	AS	ML ML
P01	First Issue	08/07/24	AS	ML ML

Hydrock
 now
Stantec

Third Floor, Wharton Place
 13 Wharton Street
 Cardiff
 CF10 1GS
 t: +44(0)2920 023665
 e: cardiff@hydrock.com

CLIENT		POBL HOMES AND COMMUNITIES	
PROJECT		RESIDENTIAL DEVELOPMENT AT GWYNFAEN (PHASE 2)	
TITLE		TYPICAL SECTIONS SHEET 2	
HYDROCK PROJECT NO.	C-21883	SCALE @ A1	AS SHOWN
STATUS DESCRIPTION	SUITABLE FOR INFORMATION	STATUS	S2
DRAWING NO.	21883-HYD-XX-XX-DR-C-2102	REVISION	P02